

# Hitachi Lift Mobile Access

The latest contactless solution that allows user to use lift without contacting any lift buttons.



## Main benefits:

### Convenience

- Users can register a destination call from anywhere in the lift lobby using their personal mobile device without crowding at hall button

### Social Distancing

- A unique Over Crowding Prevention algorithm that prevent user from getting into a crowded lift

### Hygiene

- User will use their personal mobile device to register their destination call. Without touching lift calling buttons, spreading of virus can be minimized

### User Friendly

- Two simple steps in making a call using personal mobile device. Scan QR code and select destination floor

### Versatility (\*1)

- This system can be easily added to existing lift and it works with most types of lifts from Simplex, Duplex and Group Control

Hitachi Lift Mobile Access is the latest mobile application for both Android and IOS smartphones. It allows users to register calls safely from their personal device at lift lobby without having to touch any of the lift buttons

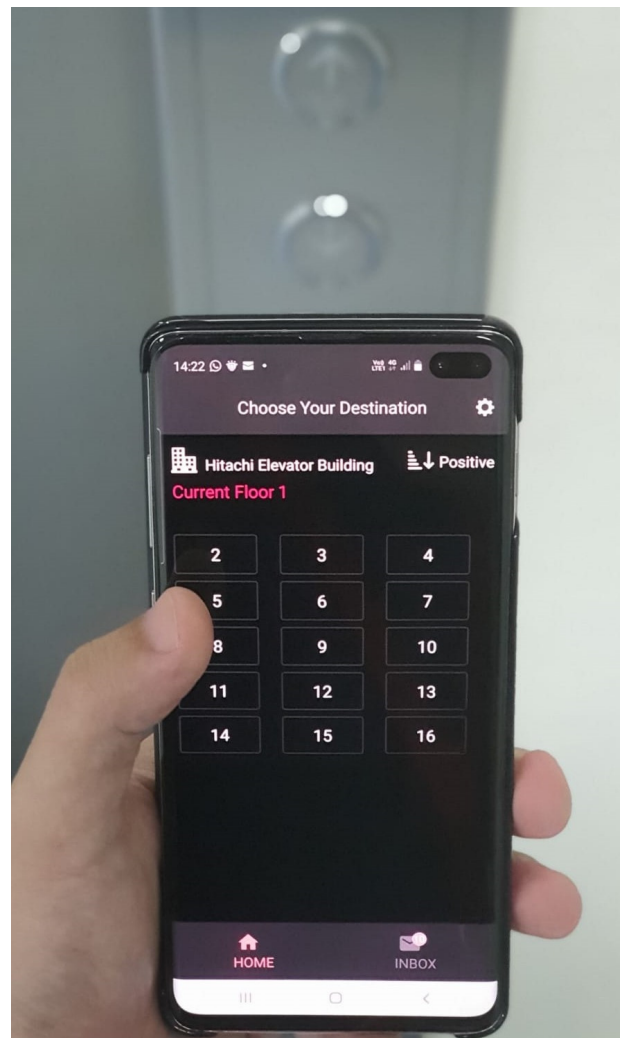

## Mobile Access User Interface

### One-time user registration

Before using Mobile Access application, user must install Mobile Access application from either Google Play Store or IOS App Store, followed by a one-time registration process through the application. Upon allowing necessary permissions, agreeing to terms and conditions, an SMS OTP will be sent to the user's mobile phone. After the OTP is verified, user can start to use the application at all Hitachi Lifts that are equipped with Mobile Access System.

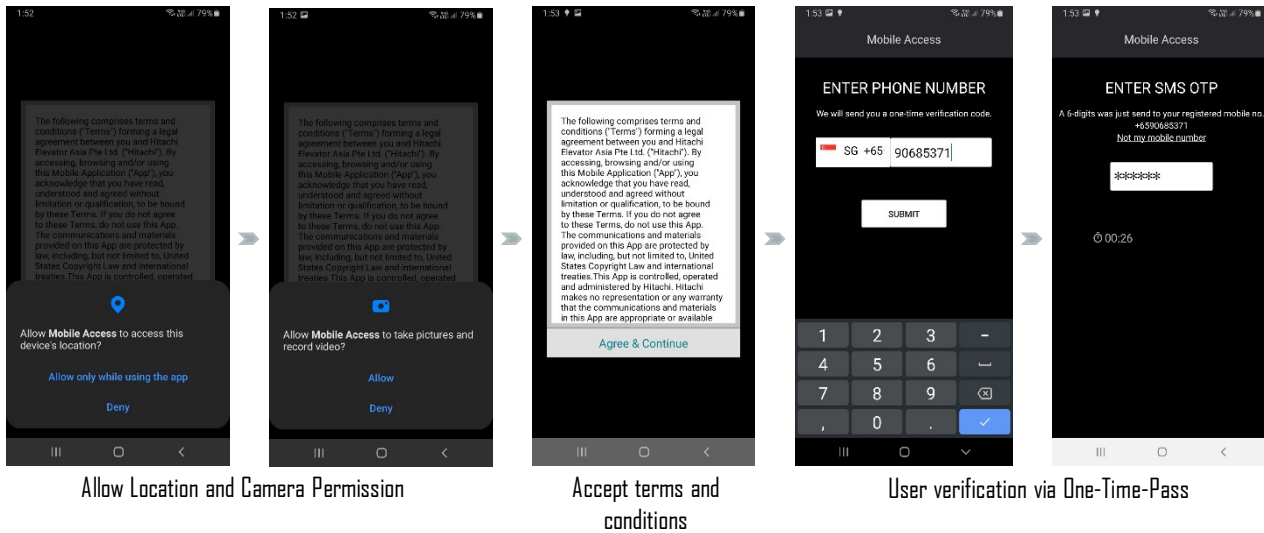

## Making a call from Mobile Access application

Launch the Mobile Access application and scan a QR code which is conveniently located in lift lobby at every floor. A list of available destination floors will be populated and displayed on the Mobile Access application. After selecting destination floor, hall call will be automatically registered.

When the next lift is approaching to the user's floor, a notification will be sent to the user's mobile phone to inform which lift to take. User shall proceed to lift entrance. After boarding the lift, in-car destination call will be automatically registered.

If the arriving lift is full or exceeds the maximum allowable no of passengers, it will send "Arriving lift is full" notification to the user. Hall call will be automatically registered after the lift has departed.

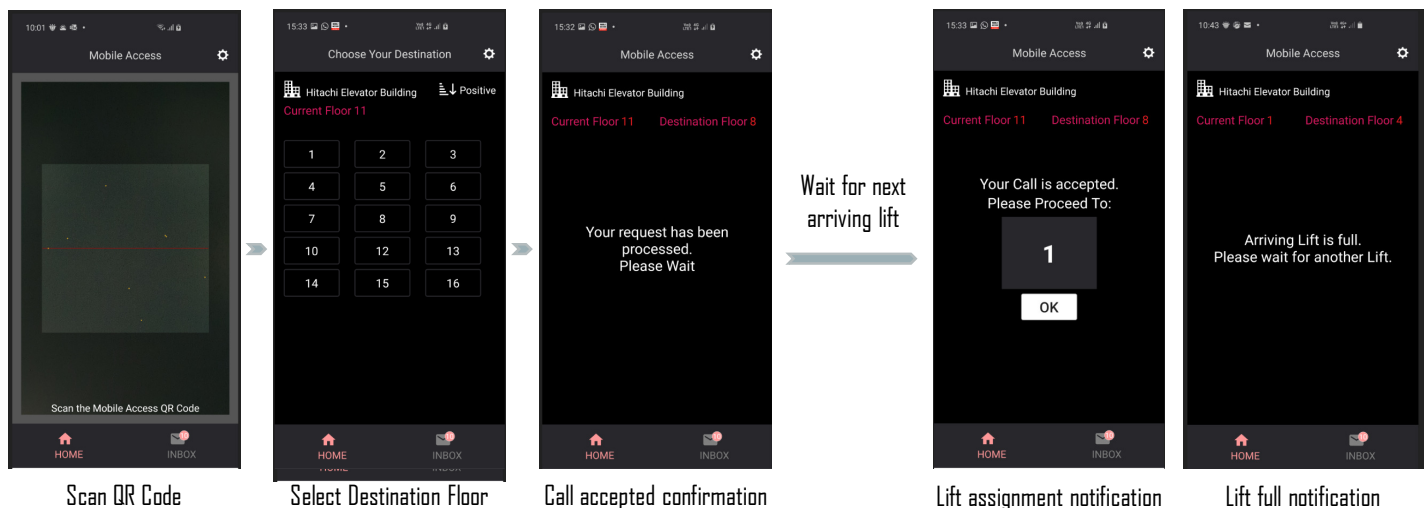

## Mobile Access System Architectual

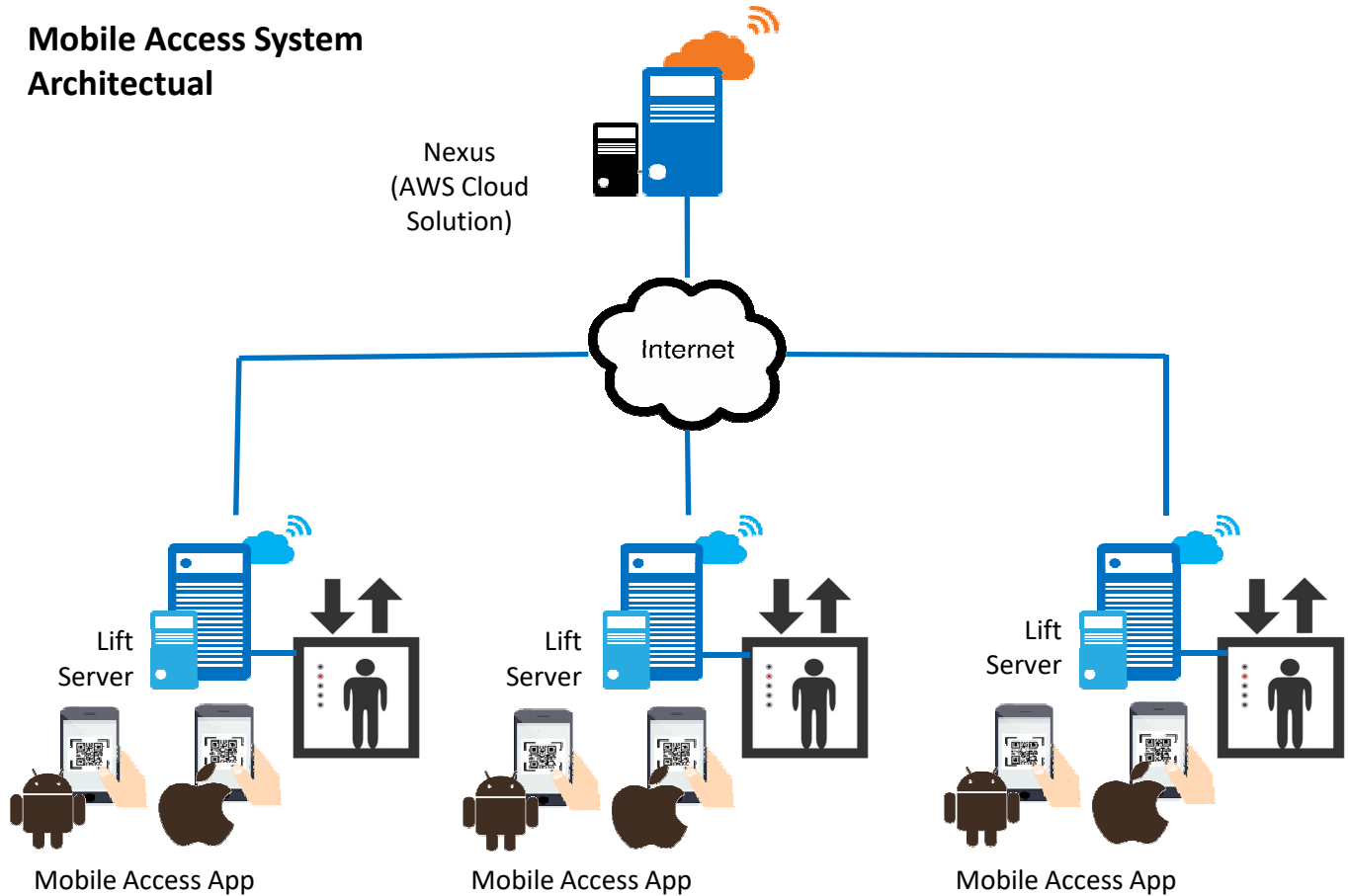

## Machine Room Configuration

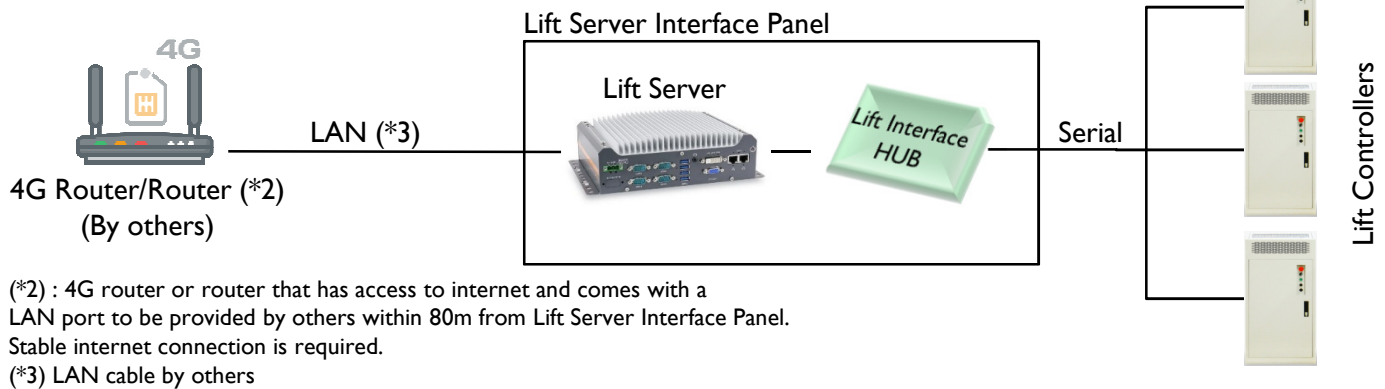

### Requirement :

1. Mobile data network should be available at all floors' lift lobby
2. QR Code poster should be located within the lift lobby at all floors
3. All users are required to register their call using Mobile Access when using the lift

Watch Video



### Contact :

Hitachi Elevator Asia Pte Ltd  
 No.10 Toh Guan Road East, Hitachi Elevator Building, Singapore 608597  
<http://www.he.a.hitachi.com.sg>

Supports Android 7.0 and IOS 11 onwards  
 Download Mobile Access App now!

